

全国免费服务热线 | **400-098-1966**
National Service Free Hotline



康达电梯有限公司
KONDA ELEVATOR CO., LTD.

地址: 江西省南昌市望城新区兴业一路 366 号
Add: No. 366, Xingye Road 1, Wangcheng New Area, Nanchang, Jiangxi
电话 (Tel): 0791-83656618 0791-83656589 0791-83656512
传真 (Fax): 0791-83656212
邮编 (P.C.): 330100
网址 (Web): www.kondalift.com

本书为一般信息类出版物, 我们保留随时更改产品和说明的权利。本书的任何字句, 无论其字面意思或含义, 对于任何产品及该产品的用途和质量, 或者任何购销合同条款的表述与更改均不承担任何责任。

This publication is for general informational purposes and we reserve the right at any time to alter product design and specification. No statement contained should be construed as warranty or condition for the purpose of lawsuit, whether expressed or implied in this book with regard to any product and its application and quality or any correctness for the contract.

2022 年 10 月份印刷



扫描二维码
关注微信公众号



扫描二维码
进入官方网站



乘客 • 电梯



INTRODUCING ADVANCED TECHNOLOGIES IN MODERN
ELEVATOR INDUSTRY
引进当代电梯业前沿科技



康达电梯有限公司

KONDA ELEVATOR CO., LTD.

康达电梯有限公司位于历史悠久、文化底蕴深厚的英雄城——江西省南昌市。占地 5 万多平方米的康达电梯生产基地就坐落于南昌市望城新区工业园，区位优势明显，航空、铁路、公路等交通方式都非常便利。

公司引进世界先进的电梯自动化控制技术，是一家集电梯研发、制造、销售、安装、维修服务于一体的专业电梯制造企业，年生产整梯能力超过 6 千台，产品涵盖高速乘客电梯、住宅电梯、医用电梯、载货电梯、观光电梯、自动扶梯、自动人行道、别墅电梯等多个系列，是国内同行中产品最多、额定载荷最大的电梯生产厂家之一。

康达电梯已获得国家质检总局颁发的 A 级资质《特种设备制造许可证》及江西省质量技术监督局颁发的 A 级资质《特种设备安装改造维修许可证》，公司产品生产已实现了标准化、规范化；从产品开发设计、供应链客户服务、合同管理到生产制造、安装维保，全程严格执行 ISO9001 质量管理体系标准，铸就了卓越的产品品质。

公司与华东交通大学机电工程学院建立了全面校企合作关系，并将每年销售收入的 5% 用于科技研发上，不断增强自主研发实力，目前已取得了 11 项软件著作权和 25 个实用新型专利，还进行了 3 个发明和 80 项实用新型专利的申报。同时，一座井道提升高度为 103.5 米、电梯运行速度可达 8 米 / 秒电梯试验塔正在建设中。

公司秉承“不断超越，做得更好”的企业精神，遵循“努力，让客户满意”的服务宗旨，构建了覆盖全国的售后服务网络和备品配件供应体系，用一流的产品、一流的服务为客户创造价值，获得了源源不断的市场生命力。

展望未来，康达电梯阔步向前，正朝着智能生产、高效节能、绝对安全的电梯方向发展，将物联网、环保能源等范围的技术全面运用到电梯、自动扶梯、楼宇综合管理服务领域，立志为全球电梯用户提供可信赖的多样化的产品和服务，为促进世界和谐发展、提升人类的生活品质而全力以赴。

ENTERPRISE INTRODUCTION

PASSENGER
ELEVATOR SERIES



Konda Elevator Co., Ltd. is located in Nanchang of Jiangxi Province, a hero city of long history and profound cultural deposits. The company's elevator production base with an area of over 50,000 square meters in the Wangcheng New Area Industrial Park of Nanchang has obvious location advantages with very convenient aviation, railways, highways and other means of transportation.

The company, introducing the most advanced elevator automatic control technology in the world, is a professional elevator manufacturing company with integration of elevator research & development, manufacturing, sales, installation and maintenance services. The company has an annual whole elevator production capacity of more than 6,000 elevators. Main products covers series of types such as the high-speed passenger elevator, residential elevator, hospital elevator, freight elevator, panoramic elevator, escalator, moving walkway, villa elevator, which makes the company one of the largest elevator manufacturers with most products and largest rated load among domestic counterparts.

Konda Elevator has obtained A-level qualification of Special Equipment Manufacturing License issued by General Administration of Quality Supervision and A-level qualification of Installation, Alteration, Repair & Maintenance License of Special Equipment issued by Jiangxi Provincial Quality and Technical Supervision and the company's production has achieved standardization and normalization; The enterprise strictly implements the ISO9001 quality management system standards from product development and design, supply chain, customer service and contract management to manufactur-

ing, installation and maintenance, thus building up the superior product quality.

The company establishes comprehensive school-enterprise cooperation with the School of Mechatronic Engineering of East China Jiaotong University and takes 5% of annual sales revenue for technical research and development to continuously enhance the independent research and development strength. So far, the company has obtained 11 software copyrights and 25 utility model patents as well as declared 3-invention and 80-utility-model patents. Meanwhile, an elevator test tower with shaft lifting height of 103.5 meters and elevator running speed of 8m/s is under construction.

The company adheres to the enterprise spirit of "Further&Better" and follows the service principle of "Do best to make customers satisfied", building up a nationwide after-sales service network and spare parts supply system, creating value for customers with first-class products and service and thus obtaining a steady stream of market vitality.

Looking into the future, Konda Elevator is advancing in big strides, moving in the direction of intelligent production, high efficiency & low energy consumption and absolutely safe elevators and applying technologies within the range of the internet of things, environmental energy and others comprehensively to elevators, escalators and building integrated management services. The company is determined to provide reliable diversified products and services for global elevator users and make effort to promote the harmonious development of the world and improvement of the life quality of human.

Advanced door machine • safety in and out

先进门机 • 进出安全

先进的 VVVF 技术，高速数字式信号处理系统，对门机的速度控制更为灵敏精确。

永磁同步门机具有低耗节能，同时具有防尘防水功能，舒适平稳特性的 VVVF 门机系统对电梯进行全闭环控制，可使门机运行有效节能 20%，可通过特殊化的图形速度曲线确保开关门加减速时的平稳性，使开关门更加平稳，噪音更低。

Advanced VVVF technology, high-speed digital signal processing system with flexible and accurate control over speed of portal crane.
Permanent magnet synchronic portal crane possesses function of low power consumption and dust and water prevention; comfortable and stable VVVF makes full-closed loop control over elevator, conserving 20% of energy effectively of portal crane operation; the stability of acceleration and deceleration can be ensured through special graphic velocity curve, making opening and closing door stable with lower noise.

Driving optimization • superior performance

优化驱动 • 性能出众

高效的新型永磁同步曳引机和先进的变频驱动系统匹配，不但比传统的曳引机节省最多 40% 的能耗，同时在提升高度、载重能力稳降噪等方面都有着出色表现。

电机无需电刷、集电环和减速箱，性能稳定、稳固耐用，大大提高楼宇交通的运送效率，并降低故障率，让电梯更长久、更稳定的为各类建筑提供服务。

The highly efficient new permanent magnet synchronous hoisting machine is combined with the advanced inverter driving system, which not only saves up to 40% of energy consumption compared with the traditional hoisting machine but also has excellent performance in the lifting height, loading capacity, noise reduction and other aspects.

The motor can run without brushes, collecting ring and reduction gearbox, which is stable, solid and durable, greatly improving the transport efficiency of buildings traffic, reducing the failure rate and making the elevator provide longer, more stable services for all types of buildings.

ADVANCED TECHNIQUE

PASSENGER
ELEVATOR SERIES

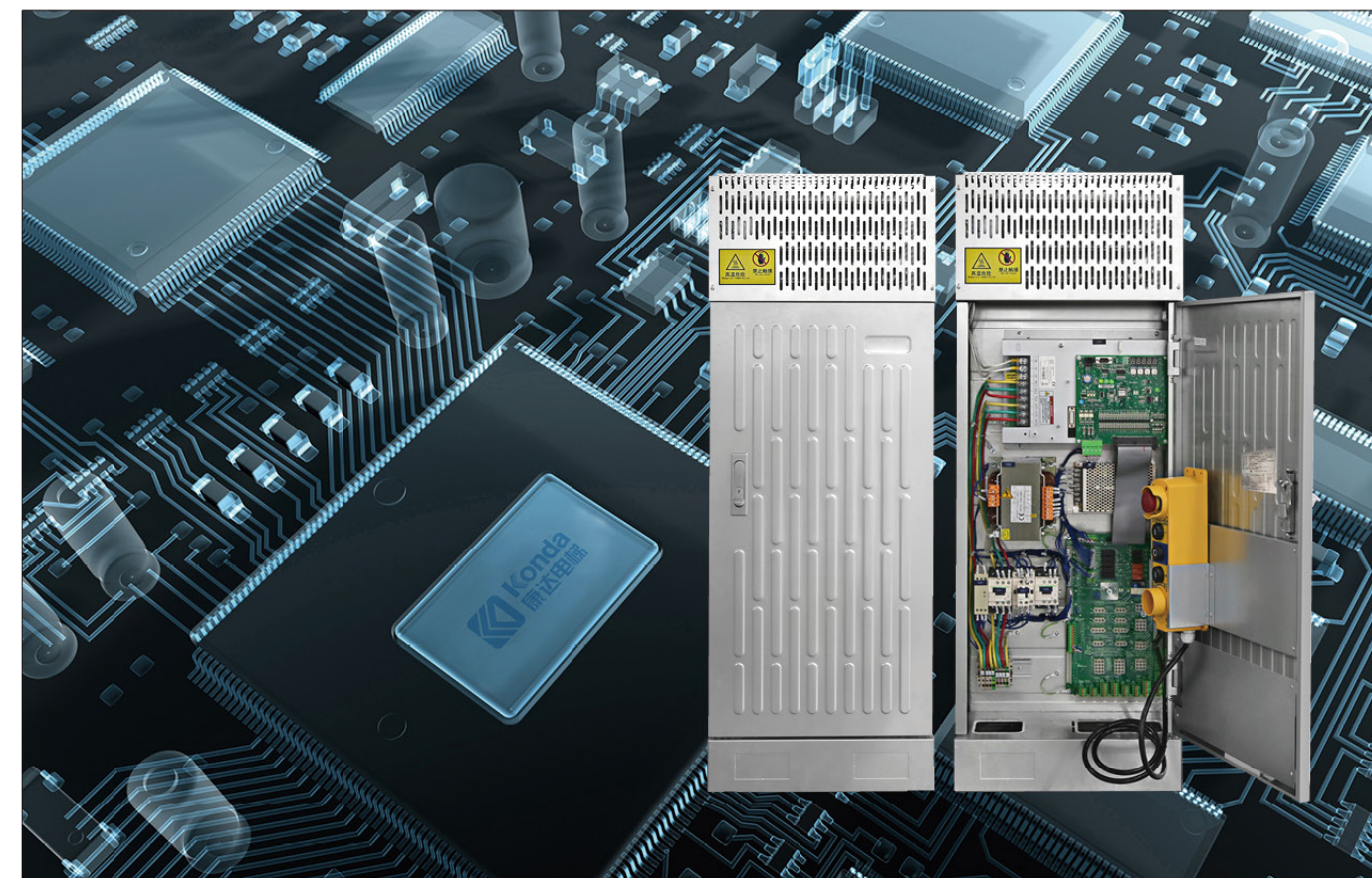

Precise control • efficient operation

精确控制 • 高效运行

采用 32 位微机一体化控制系统，数据处理更快更准，提升了系统调度及运行的速率；在任何时间都能检测到轿厢的精确位置，保证几乎为零误差的平层精度。

多微机联合控制，能预先计算减速距离，设置运行曲线，在高质量矢量变频器的驱动下，运行舒适感近乎完美。

结构紧凑，超强的抗干扰设计使控制系统不受环境干扰和影响，故障率低，可靠性高。

The company adopts 32-bit microcomputer joint control system with faster and more accurate data processing to enhance the rate of system scheduling and running, which can detect the exact position of the car at any time to ensure the leveling accuracy of almost the zero error.

With multi - computer joint control, it is possible to pre-calculate the deceleration distance and set the operating curve, so as to guarantee the almost perfect ride comfort, driven by high-quality vector inverter.

With compact structure, the powerful anti-jamming design keeps the control system from environmental interference and influence, with low failure rate and high reliability.



实力之作 垂直交通典范

Great product and model for vertical transport

90%

电能转换为光能

Electrical energy transfers into light energy

80%

比传统照明节能

Which is more energy-saving than traditional lighting.

SMALL MACHINE ROOM PASSENGER ELEVATOR

PASSENGER
ELEVATOR SERIES

Small machine room passenger elevator

小机房乘客电梯

康达小机房乘客电梯，融合了先进的安全、节能、静音等技术，将配置提升到一个崭新的水平，打造楼宇垂直交通典范之作，轻松满足酒店、写字楼、商场等场所的需求。

Konda Passenger Elevator with small machine rooms combines the advanced security, energy saving and noise-free technology, upgrades the configuration to a new level, creates a model for building vertical transportation and easily meet the needs of hotels, office buildings, shopping malls and others.

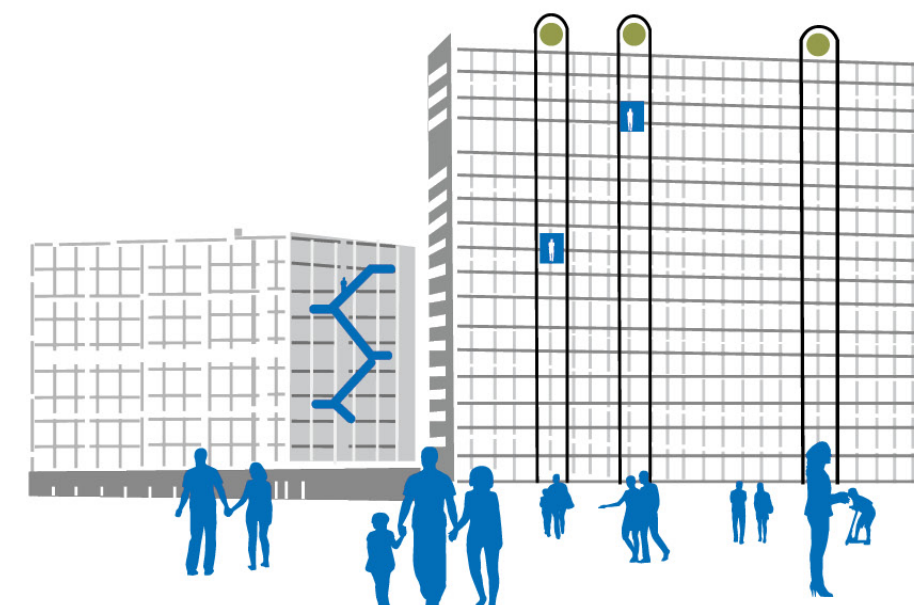

优质的小机房方案可以最大程度的利用井道空间，使业主得到更多空间 <

标准五方通话配置，避免使用及维修时出现的紧急事故 <

应用多项静音技术，在使乘客获得安静的乘坐体验的同时，大大减少对环境的噪音污染 <

LED 绿色光源照明，能将 90% 以上的电能转换为光能，与传统照明相比，可节能 80% 以上 <

可选用能量反馈装置，将电梯运行所产生的势能转换为电能回馈电网，显著降低能耗，保障绿色运行 <

可选用智能操作的控制方式，有效减少电梯运行时间并提高输送能力，而且还能定时接送指定乘客 <

The high-quality small room program can make maximum use of the hoistway space and make sure that the owners get more space.<

The standard five-way intercom configuration makes it possible to avoid emergencies in time of operation and maintenance.<

A number of noise-free technologies are applied, which significantly reduces noise pollution while the passengers get quiet ride experience.<

The lighting adopts LED green light source, which can transform more than 90% of energy to light energy and save more than 80%< energy consumption compared with traditional lighting.

The energy feedback device can be adopted to transform the potential energy generated by the elevator running back into electrical grid,< significantly reducing energy consumption and protecting the energy- saving operation.

The operation mode of intelligent control can be adopted to effectively reduce the running time, increase transmission capacity and pick up< designated passengers at regular time.



Machine roomless passenger elevator

无机房乘客电梯

康达无机房乘客电梯，将外观与功能完美结合，提供丰富设计选项的无机房方案，集成了平稳运行、节约空间和节能环保等先进技术，为现代建筑有限的空间提供了无限的创造可能，深受市场青睐。适用于高层住宅、商务楼、酒店等对土建要求较高的场所。

Konda Passenger Elevator without machine room achieves the perfect combination of form and function to provide program without machine room full of design options and integrates smooth operation, space-saving and energy-saving and other advanced technologies to provide unlimited possibility to create for limited space in modern architecture, which is favored by the market. It applies to high-rise residence, commercial buildings, hotels and other places with higher requirements on civil engineering.

稳定可靠

设计符合欧洲的精密标准，完美融合先进的驱动技术和控制技术，运行平稳舒适，减震降噪，令乘客尽享安心舒适的乘梯体验。

绿色运行

康达无机房电梯具有节能环保的特点，节约能耗的基础上，安静的运行效果还可减少对环境的噪音污染。

Stable and reliable operation

The elevator has the design that meets European precise standards, with the perfect integration of advanced driving technology and control technology, which provides smooth and comfortable operation as well as noise damping to ensure that passengers enjoy the peaceful and comfortable riding experience.

Green operation

Konda Passenger Elevator without machine room has energy-saving and environment-friendly feature and on the basis of energy conservation, the quiet operation can reduce the noise pollution on the environment.

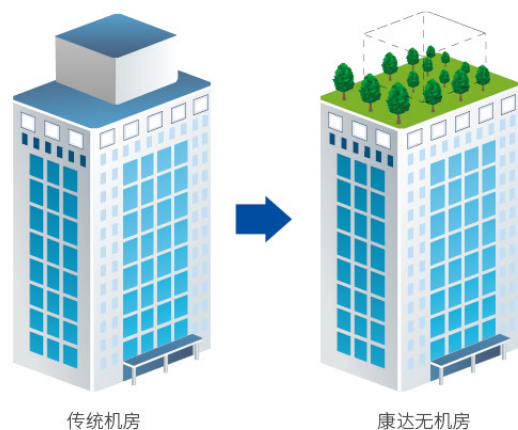

传统机房

康达无机房

MACHINE ROOMLESS PASSENGER ELEVATOR

PASSENGER
ELEVATOR SERIES



建筑优选 突破空间限制

The architectural optimization breaks through the space constraints

高效空间

康达无机房乘客电梯部件紧凑，布置灵巧合理，在相同的井道内可以提供更大尺寸的轿厢。

时尚设计

康达无机房客梯拥有多款装潢风格，从标准化到定制化，轻松实现完美搭配，满足不同楼宇设计需求。

Efficient space

Konda Passenger Elevator without engine room has compact components and smart and reasonable arrangement, providing larger size car in the same hoistway.

Fashion design

Konda Passenger Elevator without engine room has a variety of decorating styles from standardization to customization, which makes it easy to achieve the perfect match and to meet the design needs of different buildings.

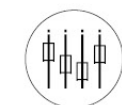

稳定可靠
Stable and
reliable operation



绿色运行
Green
operation



高效空间
Efficient space



时尚设计
Fashion design

STRETCHER ELEVATOR

PASSENGER
ELEVATOR SERIES



采用深轿厢结构
Adopting in-depth
car structure



急救安全措施
First-aid security
measures

KD-DJ001

吊顶： 镜面不锈钢上辅以筒灯的柔光照明设计
轿壁： 发纹不锈钢
地板： PVC 地板
轿门： 发纹不锈钢

Ceiling: Mirror stainless steel is supplemented by
soft lighting design of down lamp
Car wall: Hairline stainless steel
Floor: PVC floor
Car door: Hairline stainless steel

Stretcher elevator

担架电梯

康达担架电梯，依据新《住宅设计规范》的规定，专为12层及以上的高层住宅设计，兼具住户日常使用和急救双重功能，其可容纳担架的纵深轿厢，将对高层住宅中需急救的伤病人员有着至关重要的作用。

Konda Stretcher Elevator is specially designed for high-rise residence with 12 storeys or above according to provisions of residential design standards, which is of both household daily use and emergency function. The in-depth car which can accommodate a stretcher will play a vital role in rescuing patients in emergency.

特殊结构

康达担架电梯采用深轿厢结构，大载重设计，可满足120急救中心的急救担架车、折叠式急救担架车和软担架的进出要求，打造安全舒适的绿色通道。

急救功能

按下“急救”按钮，可使电梯中途不响应外呼且外呼均显示“担架急用”告知其他候梯者，从而可为病人赢得宝贵的救治时间。

Special structure

Konda stretcher elevator adopts deep lift car structure and large loading design to meet the access requirements for the emergency stretcher, folding stretcher and soft stretcher of the 120 Emergency Center and create a safe and comfortable green channel.

Emergency function

On pressing the “Emergency” button, the elevator does not respond to the hall call during the moving process and the button shows “Emergency Stretcher” to inform other waiting persons so as to win valuable rescued time for patients.

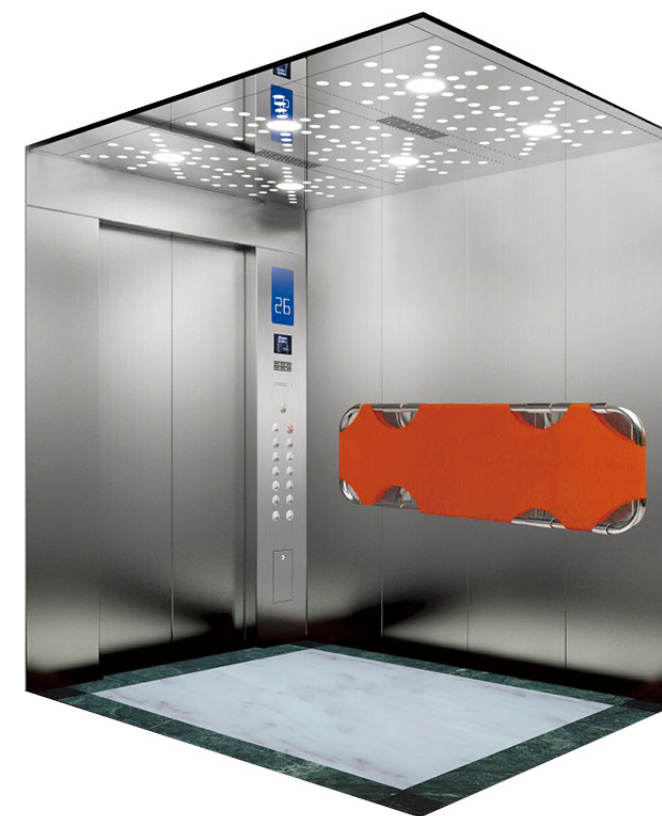

勇于担当 打造生命通道

With the courage to act and to create the life channel

KD-J001

- 吊顶：

轿壁：

地板：
- 整体镜面不锈钢，LED 照明

发纹不锈钢

PVC
- Ceiling:

Car wall:

Floor:
- Overall mirror stainless steel and LED lighting

Hairline stainless steel

PVC



扫描二维码 360 度了解轿厢
Scan the QR code to know more about the lift car in the 360-degree manner

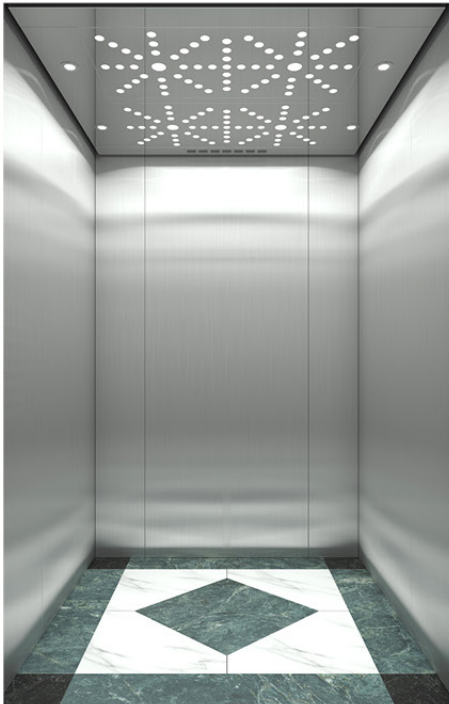

KD-J001A

- 吊顶：

轿壁：

地板：
- 整体镜面不锈钢，LED 照明

发纹不锈钢

PVC
- Ceiling:

Car wall:

Floor:
- Overall mirror stainless steel and LED lighting

Hairline stainless steel

PVC



扫描二维码 360 度了解轿厢
Scan the QR code to know more about the lift car in the 360-degree manner



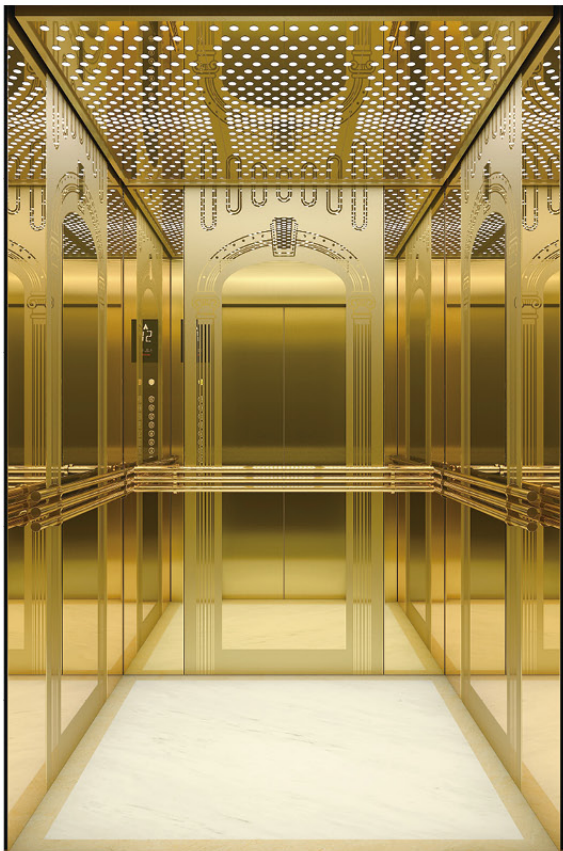

KD-J102

吊顶：镜面不锈钢框架，亚克力工艺板，筒灯
后壁：镜面不锈钢、镜面蚀刻不锈钢
侧壁：发纹不锈钢、镜面不锈钢
前壁：发纹不锈钢、镜面不锈钢
扶手：不锈钢圆扶手
地板：标配 PVC / 选配大理石

Ceiling: Mirror stainless steel frame with acrylic craft board+LED spotlight
Rear wall: Mirror etching stainless steel
Side wall: Hairline stainless steel, mirror stainless steel
Front wall: Hairline stainless steel, mirror stainless steel
Handrail: Hairline stainless steel round handrail
Floor: Standard PVC /marble optional



KD-J101

吊顶： 不锈钢镜面镂空板和白色透光板，配铝合金框架
轿壁： 钛金、镜面、蚀刻、发纹、和纹
扶手： 不锈钢管钛金三联组合
地板： PVC

Ceiling: Stainless steel mirror hollowed and white transparent board with aluminium alloy frame
Car wall: Ti-plated finish, mirror finish, etching finish, hairline finish, vibration finish
Handrail: Stainless steel tube titanium triple combination
Floor: PVC

CAR DECORATION

PASSENGER
ELEVATOR SERIES

KD-J103

吊顶：镜面不锈钢镀古铜，透光膜
后壁：长发纹不锈钢镀古铜，镜面不锈钢镀古铜边框，玻璃
侧壁：长发纹不锈钢镀古铜，镜面不锈钢镀古铜
前壁：镜面不锈钢镀古铜
地板：标配 PVC / 选配大理石

Ceiling: mirror finished stainless steel plated in titanium bronze, translucent film
Rear wall: long hairline stainless steel plated in titanium bronze, mirror finished stainless steel plated in titanium bronze, glass
Side wall: long hairline stainless steel plated in titanium bronze, mirror finished stainless steel plated in titanium bronze
Front wall: mirror finished stainless steel plated in titanium bronze
Floor: Standard PVC /marble optional



KD-J104

吊顶：镜面不锈钢，筒灯
前壁：发纹不锈钢
侧壁：镜面不锈钢，木纹钢板
后壁：木纹钢板，两侧不锈钢嵌条
轿门：发纹不锈钢
扶手：发纹不锈钢圆管
地板：标配 PVC (选配大理石)

Ceiling: Mirror stainless steel, downlight
Front wall: Hairline stainless steel
Side wall: Mirror stainless steel, wood grain steel plate
Rear wall: Wood grain steel plate, stainless steel moldings on both sides
Car door: Hairline stainless steel
Handrail: Hairline stainless steel round tube
Floor: Standard PVC(optional marble)

操纵箱
Control box



KD-C001
标配 Standard



带盲文按钮
KD-A05
(KY-A003)

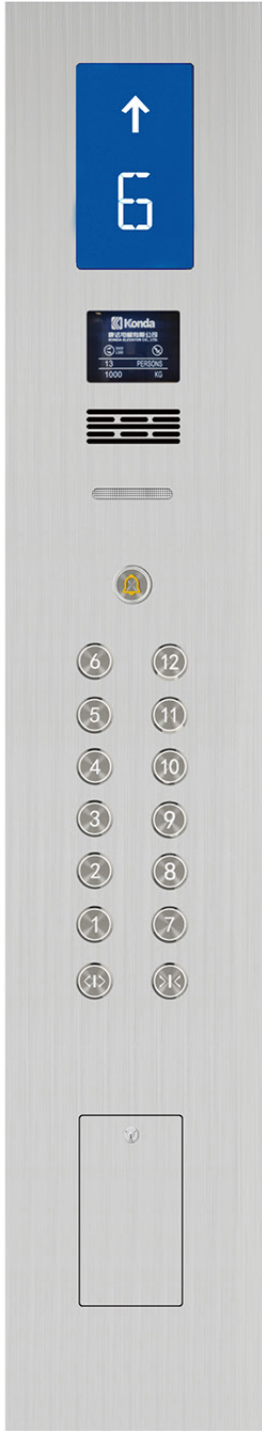

KD-C002
选配 Optional

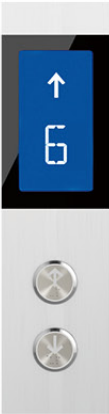

KD-C002-1

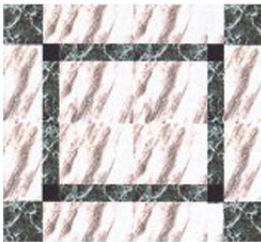

KD-B001

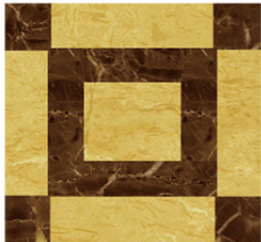

KD-B002



KD-B003

地板 (有偿选配)
Floor (Charged optional)

DECORATION
CONFIGURATION

PASSENGER
ELEVATOR SERIES

吊顶系列 Ceiling series



KD-D001
(KY-D003)
标配
镜面不锈钢框架, 筒灯
Stainless steel mirror frame,
down lamp



KD-D002
有偿选配
中间是影像平顶, 两侧为不锈钢底板
上辅以筒灯的柔光照明设计
Middle with image roof, side of stainless steel
floor with tube lamp for soft illumination design

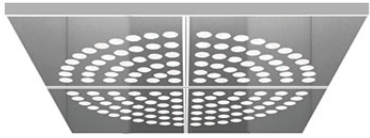

KD-D003
有偿选配
不锈钢镜面镂空板和白色有机板,
配铝合金框架
Stainless steel mirror curve and white
trans-parent board with aluminium alloy frame

厅门系列 (有偿选配) Landing door series (Charged optional)

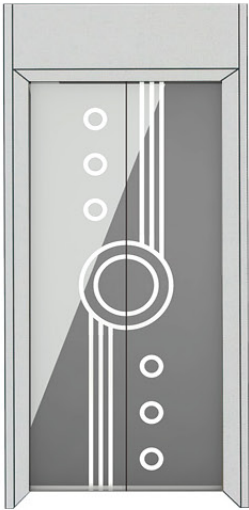

KD-T001
镜面, 蚀刻
mirror, etched



KD-T002
钛金, 镜面, 蚀刻
Titanium, mirror, etched

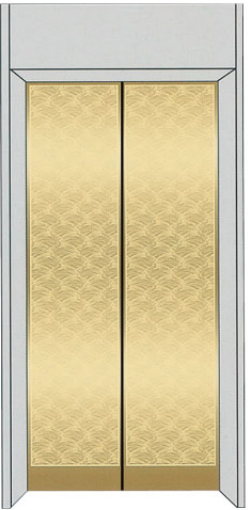

KD-T003
钛金, 镜面, 蚀刻
Titanium, mirror, etched

扶手系列 Handrail series



KD-F001



KD-F002



KD-F003



KD-F004

色卡 Colors



KD-CK01



KD-CK02



KD-CK03



KD-CK04

完美功能表

Perfect Function

标准功能

Standard function

功能名称 Function	功能说明 Description of functions
> 自动运行 Automatic operation	电梯根据给定指令自动运行、停车、开关门。 The lift automatically runs and stops, opens / shuts the door according to designated command.
> 司机运行 Operation by operator	电梯根据给定指令自动运行、停车，手动关门。 The lift automatically runs and stops, manually shuts the door according to designated command.
> 检修运行 Overhaul operation	检修状态时，通过操作慢上慢下按钮，使电梯检修速度运行。 Under repair and inspection conditions, the lift runs at inspection speed through operating "slow up / slow down" buttons.
> 自动关门延时 Automatic door-shut time-delay	轿门完全打开后，保持开门状态，经过延时后自动关门。 After the car door has been opened completely, it keeps the door open condition. It automatically shuts the door after time-delay.
> 本层外召开门 Call for opening of this floor	电梯正在关门或已关门但未启动，若本层外召，则重新开门。 When the lift is shutting the door or it does not start but has closed the door, when there is any outer calling from this landing, it will reopen the door.
> 光幕保护 Light curtain protection	光幕被遮挡时，关门动作立即停止自动开门。 When optical curtain has been shaded,it immediately stops door-shut action and automatically opens the door.
> 超载不关门 Over-load none door-shut	超载时不关门，超载灯亮，蜂鸣器鸣响，轿厢内显示 CZ 或超载，电梯不启动。 It does not shut the door in overload. And it is bright from overload lamp. The buzzer rings. It shows CZ or overload in the car and does not start the lift.
> 满载直行 Full-load direct running	达到额定载荷时，只响应内选，不响应外召。 When it reaches the rated load, it only responds to internal selection instead of outer calling.
> 自动照明控制 Automatic lighting control	规定时间内，电梯没有接收到运行指令，照明自动熄灭，有指令时自动打开。 In the stipulated time, if the lift does not receive any travel command, the lighting will automatically die out. It automatically opens at command.
> 消防返回 Firefight return	基站消防开关启动，所有指令均被取消，电梯立即驶往指定救援层站停靠。 When it starts home landing fire-fighting switch, all the commands will be cancelled then. The lift immediately drives to the designated landing and park there.
> 误操作消除 Mal-operation removal	重复操作内选按钮，即可撤销误选登记。 Repeatedly operate internal selective button to cancel mal-operation registration.
> 重复关门 Main contactor protection	执行关门指令后，在规定时间内门没有关闭到位，重新开门后再关门。 After the lift executes door-shut command, if the door has not been closed within the stipulated time, it will re-open the door and then shut it again.
> 服务楼层设置 Service floor setting	电梯仅对所设楼层进行服务。 The lift only serves the set floor.
> 基站楼层设定 Home landing floor setting	在自动状态，在一定时间内无指令时，轿厢自动运行到设定层站。 Under the automatic condition, if there is no command within certain period, the car will automatic ally run to the set landing.
> 轿内层楼、方向显示 Landing floor, direction display in the car	轿内显示电梯所在层楼及将要运行的方向。 It shows the landing floor of the lift, the direction where the lift is going to travel in the car.
> 司机选择定向 Direction chosen by driver	根据司机给定指令确定运行方向。 The running direction is determined by the driver's directive.
> 贯通门服务设置 Opposite door service setting	按照服务设置在相应楼层正确开、关门。 Correctly open / shut the door in the corresponding floor according to service setting.
> 故障诊断 Trouble diagnosis	当运行时发生故障，自动诊断故障原因，并在控制板上显示，将最近故障信息自动保存。 When there is something wrong in the travel process, it will automatically diagnose the trouble cause, display in the operation panel and automatically store the latest trouble information.
> 安全回路保护 Safety circuit protection	安全回路断开，电梯将立刻停止运行。 If safety circuit is disconnected, the lift will immediately stop the travel.
> 门联锁保护 Door interlocking protection	全部门联锁都闭合，电梯方能运行。如果运行中门联锁断开或抖动，电梯将停止运行。 If it closes all of door interlocking, it can then start the lift. If door interlocking is disconn ected or trembled, the lift will stop the operation.
> 运行接触器保护 Travel contactor protection	系统可检测电机回路接触器动作是否可靠，如果发现异常，将停止电梯运行。 The system can detect whether motor circuit contactor action is reliable or not. If any abnormal condition happens, it will stop the lift travel.

PERFECT FUNCTION

标准功能

Standard function

功能名称 Function	功能说明 Description of functions
> 抱闸检测保护 Brake test protection	通过抱闸臂检测开关对抱闸的打开与闭合实时监测。当抱闸未按要求打开时，系统将禁止电梯启动 It implement real-time monitor to the brake open / shut through brake arm test switch. If the brake has been opened improperly, the system will not allow the lift to start.
> 端站换速及楼层号校正 Terminal speed change and landing floor number correction	系统在运行中检测到端站开关后，电梯将强迫换速并自动校正楼层显示。 After the system detect terminal switch in travel, the lift will be forced to change the speed and automatically correct the landing floor display.
> 限位保护 Position-Limit protection	系统检测到限位开关动作，将立刻停止电梯运行。 If the system detects limit switch action, it will immediately stop the lift travel.
> 极限保护 Limit protection	系统检测到极限开关动作，整个系统将立刻掉电。 If the system detects limit switch action, the whole system will immediately lose power.
> 超速保护 Over-speed protection	当电梯上下行超过额定速度 1.2 倍时，切断控制电源，电梯将停止运行。 When the lift up / down exceeds 1.2 times of the rated speed, it will cut off control mains and stop the lift travel.
> 层站层楼、方向显示 Landing floor, direction display	层站显示电梯所在层楼及将要运行的方向。 The floor landing shows the landing floor that the lift travels and where it travels also.

选配功能

Optional function

功能名称 Function	功能说明 Description of functions
> 消防运行 Fire-fighting running	消防开关闭合后，系统进入消防运行。 After fire switch is closed, the system enters into fire-fighting running.
> 并联控制 Parallel connection control	两台电梯并联控制，按照快速节能原则自动响应，提高电梯运行效率 Two-lift parallel connection control automatically responds the command according to rapid energy-saving principle so as to increase the lift travel efficiency.
> 群控运行 Group supervision travel	系统可同时控制 8 台电梯运行，功能如并联控制。 The system can simultaneously control the travel of eight-lift. The function is the same as that of parallel connection control.
> 防捣乱 Anti-nuisance	电梯运行至最远端楼层清除所有的内选登记，若有负载检测装置，轻载内选最多登记 3 个。 When the lift travels to the furthest floor, it will remove all the internal selective register. If it has load tester, it will have three light-load internal selections at most.
> 应急自动平层运行 Emergency automatic leveling travel	电网停电后电梯应急自动平层控制装置供电运行平层，让乘客安全离开。 After the electric net power failure, the lift emergency automatic-leveling control device supplies power to travel leveling so that the passengers can leave there safely.
> 语音报站 Voice arrival	在正常运行到站的情况下，利用语音装置告知乘客有关信息 Under the condition of normal travel arrival, voice announcer is used to announce the related passengers' information.
> 轿厢到站钟 Car arrival gong	装于轿厢的电子钟的钟声告知乘梯的乘客电梯已到站 The electric gong that is installed in the car announces the passenger lift arrival to vast passengers.
> 厅外到站钟 Hoist-way hall arrival gong	装于待梯区的电子钟的钟声告知候梯的乘客电梯已到站。 The electronic gong in the waiting zone announces the lift arrival to the waiting passengers.
> 智能召唤服务 Intellectual calling service	只要通过专用的智能输入设备，可使轿厢指令或厅外召唤锁定或接通。 The car command or hoist-way hall calling can be locked or connected through the special intellectual input equipment.
> 残疾人服务 Service to the handicapped	专门为残疾人服务的人机界面。 Man-machine interface specially serves the handicapped people.
> 电子刷卡系统 Electronic punch card system	乘梯时需先刷卡后使用，使无卡或无权限人员无法使用电梯，加大了物业的安全管理，可有效节省大楼电力损耗。 The users shall swipe card in using the elevators. Those who do not have cards or have no jurisdiction can't use the elevators. It enlarges the safety management of the house property personnel and effectively saves power loss in the buildings.
> 能量回馈装置 Energy feedback device	使电梯的再生电力提供给大楼内，并有效地活用于大楼内的照明等，减少消耗的电量。 It offers regenerated lift power to the buildings. It is effectively applicable for lighting in the buildings etc. so as to reduce the consumed power.

小机房乘客电梯土建参数

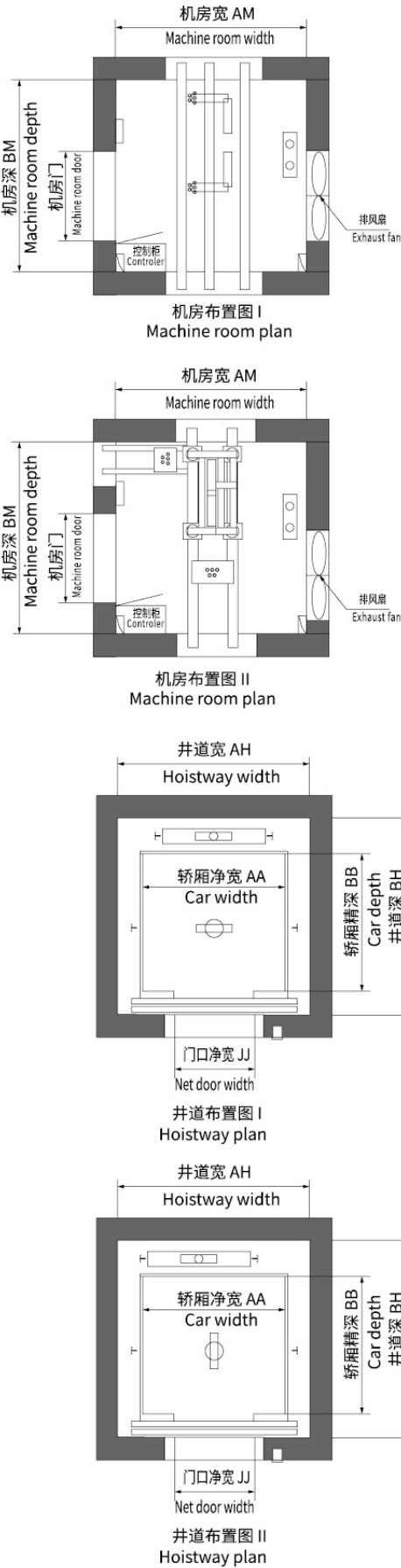
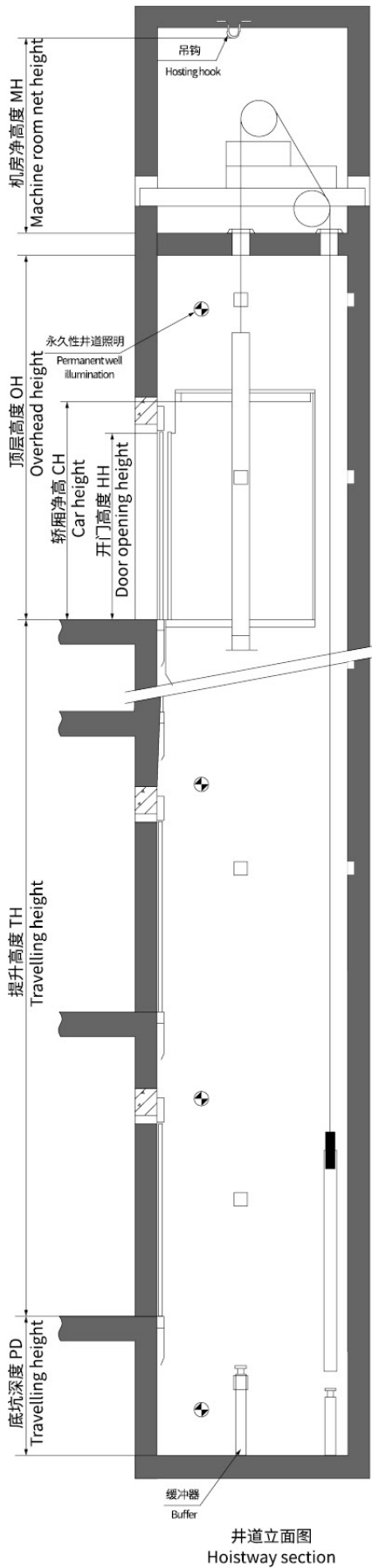

小机房乘客电梯参数表

Small machine room passenger elevator parameter table

载重量 (Kg) Loading capacity	额定速度 (m/s) Rated speed	开门宽度 (mm) Door opening width	开门高度 (mm) Door opening height	轿厢尺寸 (mm) Car size			井道尺寸 (mm) Hoistway size		机房尺寸 (mm) Machine room size		顶层高度 (mm) Top floor height	底坑深度 (mm) Pit depth	最大提升高度 (m) Max. travelling height
				宽 Width	深 Depth	高 Height	宽 Width	深 Depth	宽 Width	深 Depth			
630	1.0	800	2100	1400*1100*2350			1900*1750		1900*1750		4400	1500	50
	1.5	800	2100	1400*1100*2350			1900*1750		1900*1750		4500	1500	80
	1.75	800	2100	1400*1100*2350			1900*1750		1900*1750		4600	1600	90
800	1.0	800	2100	1400*1350*2350			2000*2000		2000*2000		4400	1500	50
	1.5	800	2100	1400*1350*2350			2000*2000		2000*2000		4500	1500	80
	1.75	800	2100	1400*1350*2350			2000*2000		2000*2000		4600	1600	90
	2.0	800	2100	1400*1350*2350			2000*2000		2000*2000		4800	1800	120
	2.5	800	2100	1400*1350*2350			2000*2000		2000*2000		5200	2200	150
1000	1.0	900	2100	1600*1400*2350			2200*2100		2200*2100		4400	1500	50
	1.5	900	2100	1600*1400*2350			2200*2100		2200*2100		4500	1500	80
	1.75	900	2100	1600*1400*2350			2200*2100		2200*2100		4600	1600	90
	2.0	900	2100	1600*1400*2350			2200*2100		2200*2100		4800	1800	120
	2.5	900	2100	1600*1400*2350			2200*2100		2200*2100		5200	2200	150
1050	1.0	900	2100	1600*1500*2350			2200*2200		2200*2200		4400	1500	50
	1.5	900	2100	1600*1500*2350			2200*2200		2200*2200		4500	1500	80
	1.75	900	2100	1600*1500*2350			2200*2200		2200*2200		4600	1600	90
	2.0	900	2100	1600*1500*2350			2200*2200		2200*2200		4800	1800	120
	2.5	900	2100	1600*1500*2350			2200*2200		2200*2200		5200	2200	150
1150	1.0	1100	2100	1800*1400*2350			2400*2100		2400*2100		4600	1600	50
	1.5	1100	2100	1800*1400*2350			2400*2100		2400*2100		4650	1650	80
	1.75	1100	2100	1800*1400*2350			2400*2100		2400*2100		4700	1700	90
	2.0	1100	2100	1800*1400*2350			2400*2100		2400*2100		4800	1800	120
	2.5	1100	2100	1800*1400*2350			2400*2100		2400*2100		5200	2200	150
1250	1.0	1100	2100	1950*1400*2350			2550*2100		2550*2100		4600	1600	50
	1.5	1100	2100	1950*1400*2350			2550*2100		2550*2100		4650	1650	80
	1.75	1100	2100	1950*1400*2350			2550*2100		2550*2100		4700	1700	90
	2.0	1100	2100	1950*1400*2350			2550*2100		2550*2100		4800	1800	120
	2.5	1100	2100	1950*1400*2350			2550*2100		2550*2100		5200	2200	150
1350	1.0	1100	2100	1950*1500*2350			2550*2200		2550*2200		4600	1600	50
	1.5	1100	2100	1950*1500*2350			2550*2200		2550*2200		4650	1650	80
	1.75	1100	2100	1950*1500*2350			2550*2200		2550*2200		4700	1700	90
	2.0	1100	2100	1950*1500*2350			2550*2200		2550*2200		4800	1800	120
	2.5	1100	2100	1950*1500*2350			2550*2200		2550*2200		5200	2200	150
1600	1.0	1100	2100	1950*1750*2350			2550*2350		2550*2350		4600	1600	50
	1.5	1100	2100	1950*1750*2350			2550*2350		2550*2350		4650	1650	80
	1.75	1100	2100	1950*1750*2350			2550*2350		2550*2350		4700	1700	90
	2.0	1100	2100	1950*1750*2350			2550*2350		2550*2350		4800	1800	120
	2.5	1100	2100	1950*1750*2350			2550*2350		2550*2350		5200	2200	150

无机房乘客电梯土建参数

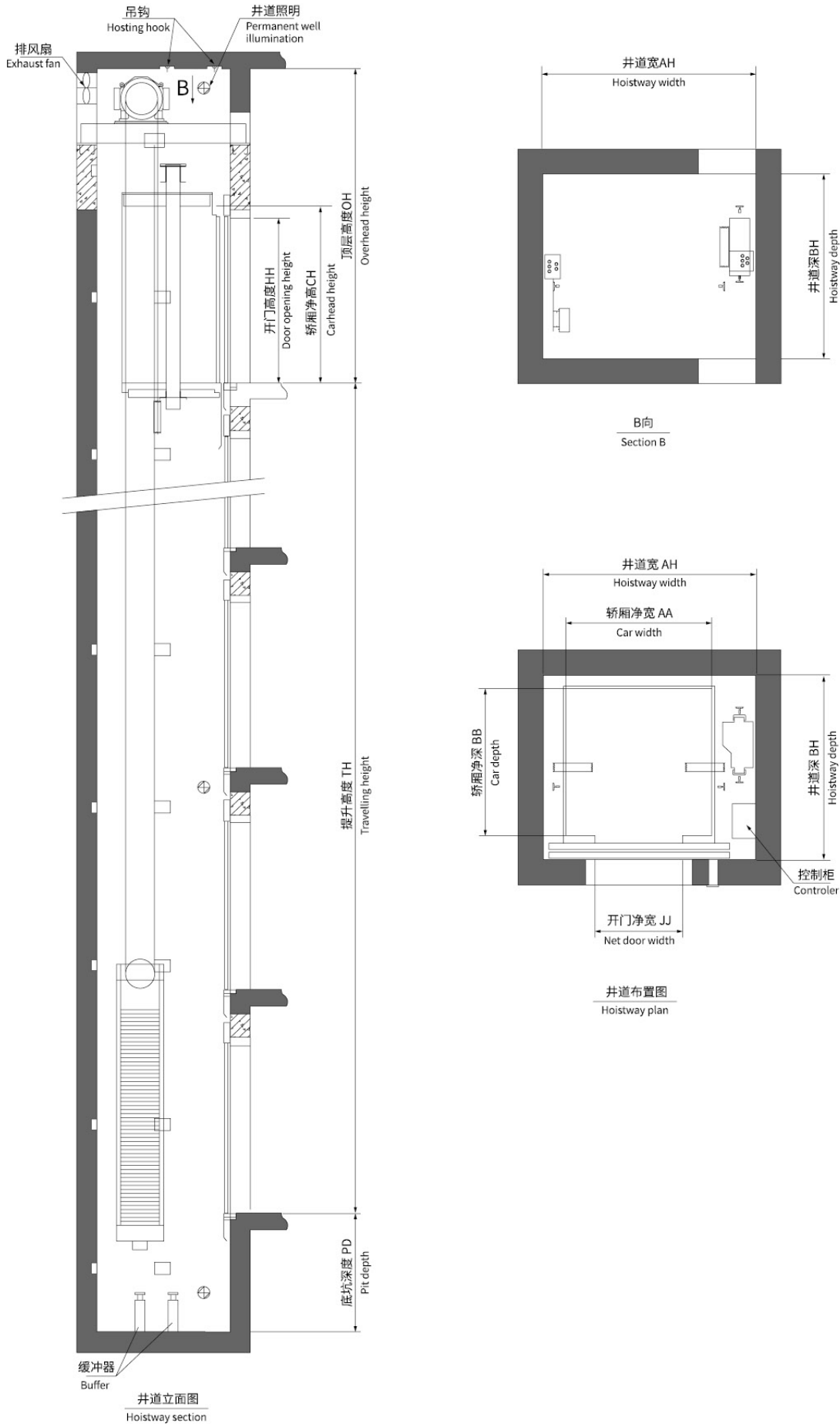

无机房乘客电梯参数表

Machine roomless passenger elevator parameter table

载重量 (Kg) Loading capacity	额定速度 (m/s) Rated speed	开门宽度 (mm) Door opening width	开门高度 (mm) Door opening height	轿厢尺寸 (mm) Car size 宽 Width 深 Depth 高 Height	井道尺寸 (mm) Hoistway size 宽 Width 深 Depth	顶层高度 (mm) Top floor height	底坑深度 (mm) Pit depth	最大提升高度 (m) Max.travelling height
630	1.0	800	2100	1100*1400*2350	2000*1800	4200	1500	50
	1.5	800	2100	1100*1400*2350	2000*1800	4300	1500	50
	1.75	800	2100	1100*1400*2350	2000*1800	4500	1600	60
800	1.0	800	2100	1400*1350*2350	2200*1800	4200	1500	50
	1.5	800	2100	1400*1350*2350	2200*1800	4300	1500	50
	1.75	800	2100	1400*1350*2350	2200*1800	4500	1600	60
1000	1.0	900	2100	1600*1400*2350	2400*1900	4200	1500	50
	1.5	900	2100	1600*1400*2350	2400*1900	4300	1500	60
	1.75	900	2100	1600*1400*2350	2400*1900	4500	1600	80
1150	1.0	1000	2100	1500*1700*2350	2300*2200	4200	1500	50
	1.5	1000	2100	1500*1700*2350	2300*2200	4300	1600	60
	1.75	1000	2100	1500*1700*2350	2300*2200	4500	1700	80
1250	1.0	1000	2100	1600*1700*2350	2400*2200	4200	1500	50
	1.5	1000	2100	1600*1700*2350	2400*2200	4300	1600	60
	1.75	1000	2100	1600*1700*2350	2400*2200	4500	1700	80
1350	1.0	1100	2100	1600*1800*2350	2400*2300	4200	1500	50
	1.5	1100	2100	1600*1800*2350	2400*2300	4300	1600	60
	1.75	1100	2100	1600*1800*2350	2400*2300	4500	1700	80
1600	1.0	1100	2100	1800*1900*2350	2900*2300	4200	1500	50
	1.5	1100	2100	1800*1900*2350	2900*2300	4300	1600	60
	1.75	1100	2100	1800*1900*2350	2900*2300	4500	1700	80

担架电梯土建参数

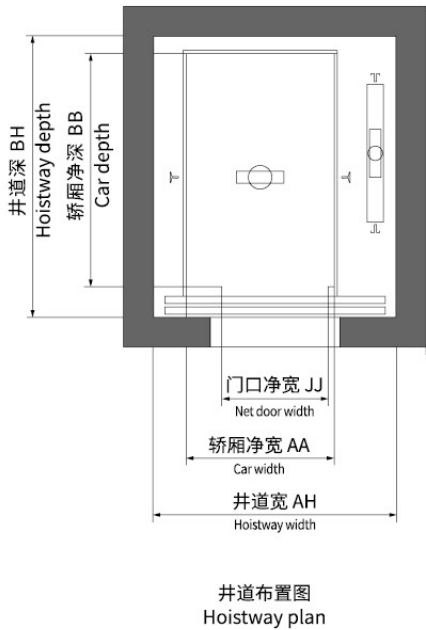
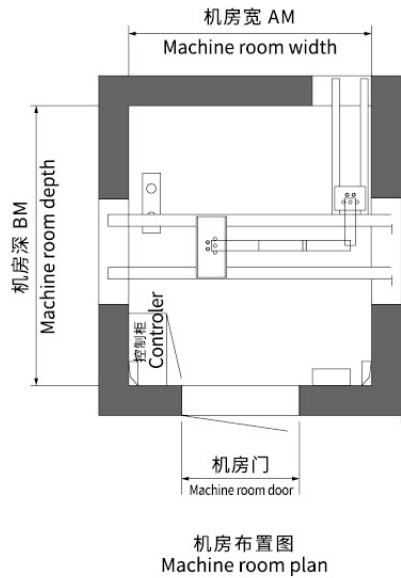
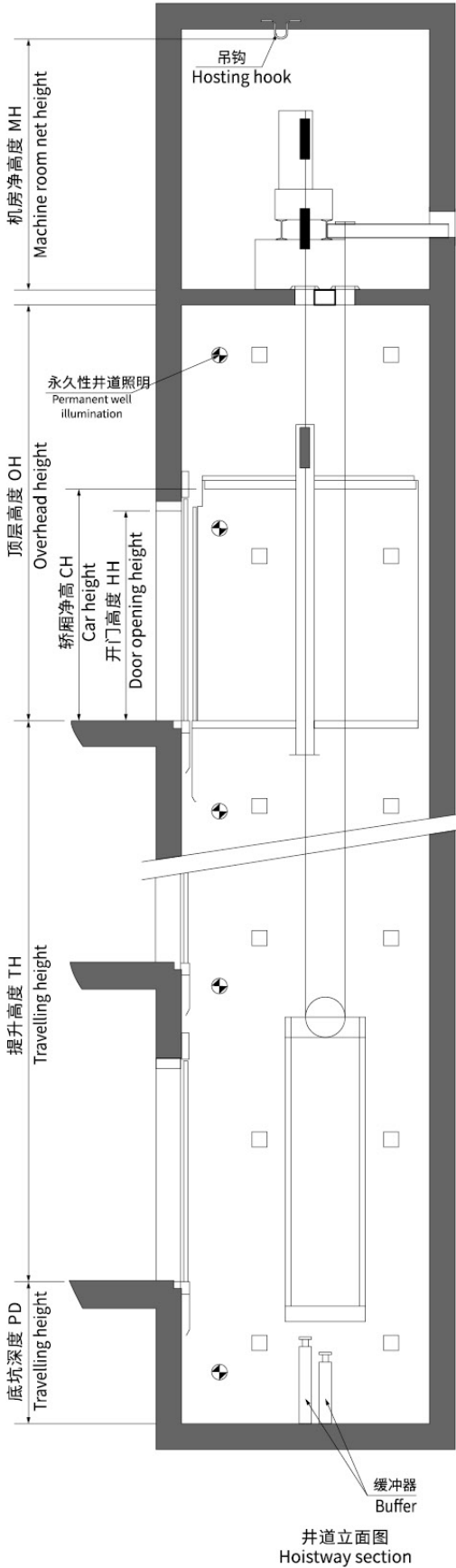

担架电梯参数表

Stretcher elevator parameter table

载重量 (Kg) Loading capacity	额定速度 (m/s) Rated speed	开门宽度 (mm) Door opening width	开门高度 (mm) Door opening height	轿厢尺寸 (mm) Car size			井道尺寸 (mm) Hoistway size		机房尺寸 (mm) Machine room size		顶层高度 (mm) Top floor height	底坑深度 (mm) Pit depth	最大提升高度 (m) Max. travelling height
				宽 Width	深 Depth	高 Height	宽 Width	深 Depth	宽 Width	深 Depth			
1000	1.0	900	2100	1100*2100*2350			2100*2600		2100*2600		4400	1400	50
	1.5	900	2100	1100*2100*2350			2100*2600		2100*2600		4500	1400	80
	1.75	900	2100	1100*2100*2350			2100*2600		2100*2600		4600	1450	90/105/120
	2.0	900	2100	1100*2100*2350			2100*2600		2100*2600		4800	1600	80/105/120
1050	1.0	900	2100	1250*1950*2350			2100*2400		2100*2400		4400	1400	50
	1.5	900	2100	1250*1950*2350			2100*2400		2100*2400		4500	1400	80
	1.75	900	2100	1250*1950*2350			2100*2400		2100*2400		4600	1450	90/105/120
	2.0	900	2100	1250*1950*2350			2100*2400		2100*2400		4800	1600	80/105/120
1150	1.0	900	2100	1200*2100*2350			2200*2600		2200*2600		4400	1700	50
	1.5	900	2100	1200*2100*2350			2200*2600		2200*2600		4500	1700	80
	1.75	900	2100	1200*2100*2350			2200*2600		2200*2600		4600	1750	90/105/120
	2.0	900	2100	1200*2100*2350			2200*2600		2200*2600		4800	1800	80/105/120
1250	1.0	1100	2100	1300*2100*2350			2300*2600		2300*2600		4400	1700	50
	1.5	1100	2100	1300*2100*2350			2300*2600		2300*2600		4500	1700	80
	1.75	1100	2100	1300*2100*2350			2300*2600		2300*2600		4600	1750	90/105/120
	2.0	1100	2100	1300*2100*2350			2300*2600		2300*2600		4800	1800	80/105/120
1350	1.0	1200	2100	1400*2100*2350			2400*2600		2400*2600		4400	1700	50
	1.5	1200	2100	1400*2100*2350			2400*2600		2400*2600		4500	1700	80
	1.75	1200	2100	1400*2100*2350			2400*2600		2400*2600		4600	1750	90/105/120



专业维保团队
Professional repair & maintenance team



售后备件体系
After-sale spare parts system



服务热线
Service hotline

Dedicated to building a sound service system

全力以赴 打造完善的服务体系

康达电梯凭借一流的技术、丰富的管理经验以及优良的服务，对所提供的产品进行科学的保养和严格的质量监控。选择康达电梯，就是选择了一套完整的服务体系。

Konda Elevator carries out scientific maintenance and strict quality control on its products with first-class technologies, rich management experience and excellent services. Choosing Konda Elevator is choosing a complete set of service system.

专业的安装维保团队

公司拥有一支经验丰富的安装维保团队，定期进行专业知识培训，使每位员工都能不断提高自己的安装维修水平，以便更好地为客户服务。

完备的售后备件供应体系

公司奉行“以顾客为中心”的企业宗旨，售后服务网络覆盖全国范围各大中小城市，完善的备品配件供应体系，可就近取材，确保以最快的速度提供最优的服务。

24 小时服务热线

专门开通 24 小时服务热线，第一时间提供电梯相关的各种咨询及意见。

Professional installation & maintenance team

The company has an experienced installation and maintenance team, with regular professional training, to make each employee continue to improve their installation and maintenance skills in order to better serve our customers.

Complete after-sale and spare parts supply system

The company sticks to “customer-centric” business purposes, with a nationwide after-sale service network covering all sizes of cities. The complete spare parts supply system makes it possible to supply any spare parts from the nearest place to ensure the best service at fastest speed.

24-hour service hotline

A 24-hour hotline is specially opened in order to provide a variety of elevator-related consulting and advice.



专业的服务内容

“预防为主、预检、预修”对出现磨损的部件和老化过时的系统，保留有价值的关键部件，增设附属硬件或系统更新。

Professional service contents

Precaution-oriented pre-inspection & repair: Keep valuable key parts and add accessory hardware or update software against the appearance of worn parts and the aged/outdated system.



电梯远程监控系统

实现 24 小时电梯状态远程监控、及时报警救援和维保、检验等工作的信息化管理，保障电梯安全运行，电梯管理更方便快捷。

Remote elevator monitoring system

Achieving informatization management of operations such as 24-hour remote elevator monitoring, timely alarm along with rescue and maintenance, inspection etc so as to guarantee elevator's safe operation and carry out more convenient and efficient elevator management.

